



# COMPACT MOTORHOME RANGE

## SHERWOOD

**Surprisingly spacious. Amazingly agile. Totally iconic...**

The Sherwood is Suncamper distilled. Spacious and agile, it's at home in the city or country, fits a single car space yet can take you around Australia in total comfort. Two-wheel drive or four, the Sherwood is the ultimate personal escape machine for the adventurer within...

### SUNCAMPER MOTORHOMES

MD19015

A division of Suncamper Pty Ltd

9 Sefton Road

Thornleigh NSW 2120

T 1300 416 854

[www.suncampermotorhomes.com.au](http://www.suncampermotorhomes.com.au)

[sales@suncampermotorhomes.com.au](mailto:sales@suncampermotorhomes.com.au)

## SUNCAMPER MOTORHOMES

**Suncamper has made recreational vehicles for nearly half a century and our goal has never changed: Create quality that provides freedom and the ultimate lifestyle...**

Australian owned and operated, we pride ourselves on motorhomes specifically built to conquer Australia's harsh conditions. From concept to creation, every Suncamper is the result of decades of experience from some of the Industry's most highly regarded innovators.

Built using proven techniques backed by industry and engineering certification, every Suncamper is manufactured to the highest standards. The result is excellent value, long service life, and high regard at resale time. It's what makes a Suncamper a Suncamper...



### SUNCAMPER MOTORHOMES

MD19015

A division of Suncamper Pty Ltd

9 Sefton Road

Thornleigh NSW 2120

T 1300 416 854

[www.suncampermotorhomes.com.au](http://www.suncampermotorhomes.com.au)

[sales@suncampermotorhomes.com.au](mailto:sales@suncampermotorhomes.com.au)

## SHERWOOD

### R-SERIES

- ✓ Entry level RV
- ✓ Queen-sized bed
- ✓ Kids seats optional
- ✓ Perfect for families
- ✓ Shower & toilet
- ✓ Panoramic windows



### E-SERIES

- ✓ Queen-sized bed
- ✓ European Styling
- ✓ Pull out pantry
- ✓ Customisable Accessories
- ✓ Original Model of 30+ years
- ✓ Panoramic windows



SINGLE BEDS

### S-SERIES

- ✓ L-shape lounge
- ✓ Tunnel Boot
- ✓ Rear door entry
- ✓ Queen or 2 x single opt\*
- ✓ Larger fridge
- ✓ Combo stove & sink

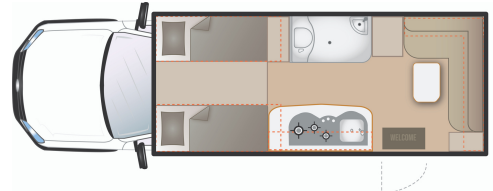

SINGLE BEDS

### T-SERIES

- ✓ Swivel table
- ✓ Large Internal Storage
- ✓ Rear door entry
- ✓ Queen or 2 x single opt\*
- ✓ Seperate Shower & WC
- ✓ Large kitchen bench

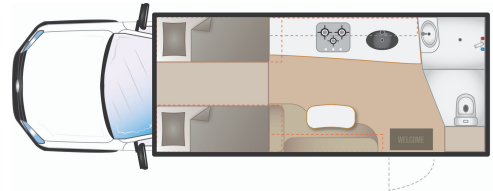

### L-SERIES

- ✓ Longer bed
- ✓ Pocket table
- ✓ Rear dinette
- ✓ Longer & wider living area
- ✓ Seperate Shower & WC
- ✓ Panoramic windows



### CONQUEROR

- ✓ Top of the Range
- ✓ Stone top Benches
- ✓ Queen Bed
- ✓ Wide Range of Accessories
- ✓ Roof racks & Brush bars
- ✓ Increased storage & GVM

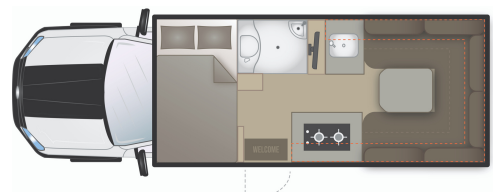





**SUNCAMPER MOTORHOMES**

MD19015

A division of Suncamper Pty Ltd

9 Sefton Road  
Thornleigh NSW 2120

T 1300 416 854

[www.suncampermotorhomes.com.au](http://www.suncampermotorhomes.com.au)

[sales@suncampermotorhomes.com.au](mailto:sales@suncampermotorhomes.com.au)

## SHERWOOD 4X4

The Sherwood 4x4 is our hero model and Australia's top-selling 4x4 motorhome.

Built on the unbreakable Toyota Hilux and ever reliable Ford Ranger, for more than 30 years, the Sherwood; is tough, tested, and proven off-road, right across the country.

Featuring a comfortable over-cab bed, spacious lounge with wrap-around views, full kitchen, and the luxury of a private bathroom for that end-of-adventure hot shower, it's your home – well, away from home...



## LICENSING & MORE

You only need a car licence for most Suncamper recreational vehicles, so your new life can start sooner! We also continuously develop models to keep Suncamper motorhomes at the leading edge of innovation in materials, technologies and enjoyment, which means features and information may change without notice.

### SUNCAMPER MOTORHOMES

MD19015

A division of Suncamper Pty Ltd

9 Sefton Road

Thornleigh NSW 2120

T 1300 416 854

[www.suncampermotorhomes.com.au](http://www.suncampermotorhomes.com.au)

[sales@suncampermotorhomes.com.au](mailto:sales@suncampermotorhomes.com.au)

## THE BUILD

Your Suncamper is built from the highest quality materials to ensure our products are finished immaculately. With a solar steel frame serving as your base, your Suncamper Motorhome is robust & ready for your Australian adventures. Keeping you secure is Suncamper's strong 4S composite constructed fibreglass walls. Sandwiching fire retardant insulation, these walls are cut down to the mm on our state of the art CNC machine. Sculpted & assembled through 30+ years of R&D our shells are designed to keep water & dust out no matter the environment. With various anchor points throughout, your cabinetry is strong enough to be self supporting, but partners comprehensively with our 4S walls.

We pride ourselves on our build quality, ensuring your Suncamper is set for all your adventures for many years to come.



### SUNCAMPER MOTORHOMES

MD19015

A division of Suncamper Pty Ltd

9 Sefton Road  
Thornleigh NSW 2120

T 1300 416 854

[www.suncampermotorhomes.com.au](http://www.suncampermotorhomes.com.au)  
[sales@suncampermotorhomes.com.au](mailto:sales@suncampermotorhomes.com.au)

**R SERIES**

**E SERIES**

**S SERIES**

**T SERIES**

**L SERIES**

**CONQUEROR**
**PREMIUM**

	<b>R SERIES</b>	<b>E SERIES</b>	<b>S SERIES</b>	<b>T SERIES</b>	<b>L SERIES</b>	<b>CONQUEROR</b>
<b>LENGTH</b>	<b>5800</b>	<b>5800</b>	<b>5800</b>	<b>5800</b>	<b>5800</b>	<b>5850</b>
<b>WIDTH</b>	<b>2100</b>	<b>2100</b>	<b>2100</b>	<b>2100</b>	<b>2300</b>	<b>2100</b>
<b>HEIGHT</b>	<b>2850</b>	<b>3250</b>	<b>3250</b>	<b>3250</b>	<b>3250</b>	<b>3100</b>
<b>2WD P</b>	<b>2.7L</b>	<b>2.7L</b>	<b>-</b>	<b>2.7L</b>	<b>-</b>	<b>-</b>
<b>2WD D</b>	<b>2.4L OR 2L</b>	<b>2.4L OR 2L</b>	<b>-</b>	<b>2.4L OR 2L</b>	<b>-</b>	<b>-</b>
<b>4WD HILUX</b>	<b>-</b>	<b>2.8L T</b>	<b>2.8L T</b>	<b>2.8L T</b>	<b>2.8L T</b>	<b>2.8L T</b>
<b>4WD RANGER</b>	<b>-</b>	<b>2L BI T</b>	<b>2L BI T</b>	<b>2L BI T</b>	<b>2L BI T</b>	<b>2L BI T</b>
<b>GVM KG</b>	<b>3180</b>	<b>3500</b>	<b>3500</b>	<b>3500</b>	<b>3620*</b>	<b>3620</b>
<b>TARE KG</b>	<b>2335</b>	<b>2680</b>	<b>2680</b>	<b>2680</b>	<b>2800</b>	<b>2995</b>
<b>BERTH</b>	<b>2+2</b>	<b>2+2</b>	<b>2</b>	<b>2</b>	<b>2+2</b>	<b>2+2</b>
<b>AIR CON</b>	<b>OPT.</b>	<b>Y</b>	<b>Y</b>	<b>Y</b>	<b>Y</b>	<b>OPT.</b>
<b>LCD T.V.</b>	<b>OPT.</b>	<b>Y</b>	<b>Y</b>	<b>Y</b>	<b>Y</b>	<b>Y</b>
<b>12V FRIDGE</b>	<b>105</b>	<b>105</b>	<b>150</b>	<b>105</b>	<b>150</b>	<b>105</b>
<b>SOLAR PANEL</b>	<b>OPT.</b>	<b>135</b>	<b>135</b>	<b>135</b>	<b>135</b>	<b>405</b>
<b>STOVE</b>	<b>3-BURNER</b>	<b>3-BURNER</b>	<b>3-BURNER</b>	<b>3-BURNER</b>	<b>3-BURNER</b>	<b>2-BURNER</b>
<b>SINK</b>	<b>Y</b>	<b>Y</b>	<b>Y</b>	<b>Y</b>	<b>Y</b>	<b>Y</b>
<b>MICROWAVE</b>	<b>Y</b>	<b>Y</b>	<b>Y</b>	<b>Y</b>	<b>Y</b>	<b>OPT.</b>
<b>SHWR &amp; WC</b>	<b>Y</b>	<b>Y</b>	<b>Y</b>	<b>SEPARATE</b>	<b>SEPARATE</b>	<b>Y</b>
<b>FRESH WATER</b>	<b>86L</b>	<b>86L</b>	<b>86L</b>	<b>86L</b>	<b>86L</b>	<b>138L</b>
<b>WASTE TANK</b>	<b>43L</b>	<b>43L</b>	<b>43L</b>	<b>43L</b>	<b>43L</b>	<b>43L</b>
<b>SCREEN DOOR</b>	<b>LOCKABLE</b>	<b>LOCKABLE</b>	<b>LOCKABLE</b>	<b>LOCKABLE</b>	<b>LOCKABLE</b>	<b>LOCKABLE</b>
<b>BATTERY</b>	<b>AGM</b>	<b>AGM</b>	<b>AGM</b>	<b>AGM</b>	<b>AGM</b>	<b>LITHIUM</b>
<b>STEP</b>	<b>MANUAL</b>	<b>ELECTRIC</b>	<b>ELECTRIC</b>	<b>ELECTRIC</b>	<b>ELECTRIC</b>	<b>ELECTRIC</b>
<b>AWNING</b>	<b>OPT.</b>	<b>Y</b>	<b>Y</b>	<b>Y</b>	<b>Y</b>	<b>Y</b>
<b>PANORAMIC WINDOWS</b>	<b>Y</b>	<b>Y</b>	<b>PARTIAL</b>	<b>-</b>	<b>Y</b>	<b>Y</b>

\*DUE TO CONSTANT DEVELOPMENT, FEATURES AND INFORMATION MAY CHANGE WITHOUT NOTICE.

**SUNCAMPER MOTORHOMES**

MD19015

A division of Suncamper Pty Ltd

9 Sefton Road

Thornleigh NSW 2120

T 1300 416 854

[www.suncampermotorhomes.com.au](http://www.suncampermotorhomes.com.au)
[sales@suncampermotorhomes.com.au](mailto:sales@suncampermotorhomes.com.au)