



# COMPACT MOTORHOME RANGE

## SHERWOOD

If you like things spacious yet agile...

Our most popular motorhome is the Sherwood. We know you value being able to park in a car spot, drive at ease on the freeway and not be worried about going up dirt roads. Versatility and agility are important to you. You like to be able to get up and move quickly if you want to.

**SUNCAMPER MOTORHOMES**

A division of Suncamper Pty Ltd

Unit 3  
9 Sefton Road  
Thornleigh NSW NSW 2100

T 1300 416 854  
[www.suncampermotorhomes.com.au](http://www.suncampermotorhomes.com.au)  
[sales@suncampermotorhomes.com.au](mailto:sales@suncampermotorhomes.com.au)

## SUNCAMPER MOTORHOMES

**Suncamper has been manufacturing high quality motorhomes and recreational vehicles for nearly half a century..**

We are 100% Australian owned and operated and pride ourselves on producing motorhomes that are suitable for harsh Australian travelling conditions.

From concept to delivery, every step has expert guidance from people with years of industry experience. The end goal is to produce vehicles that create a freedom and lifestyle as broad as the imagination.

It is the way in which the vehicles are manufactured that sets Suncamper Motorhomes apart from other manufacturers. Long, established experience in construction and in the industry have made Suncamper one of the highest quality motorhome builders today. Models are constantly upgraded and improved.

Suncamper Motorhomes are well built, have a considerably long life and can be sold at a very high re-sale value.



**SUNCAMPER MOTORHOMES**

A division of Suncamper Pty Ltd

Unit 3  
9 Sefton Road  
Thornleigh NSW NSW 2100

T 1300 416 854  
[www.suncampermotorhomes.com.au](http://www.suncampermotorhomes.com.au)  
[sales@suncampermotorhomes.com.au](mailto:sales@suncampermotorhomes.com.au)

## SHERWOOD

**R-SERIES**

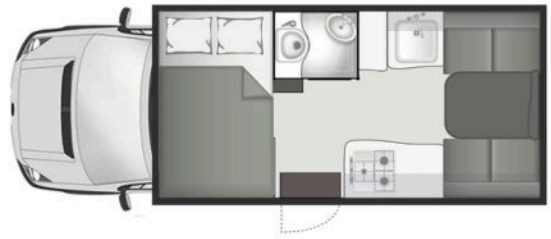

**E-SERIES**

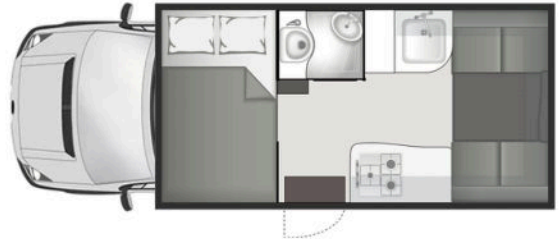

**S-SERIES**

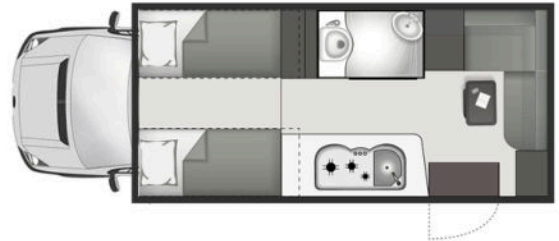

**T-SERIES**



**L-SERIES**

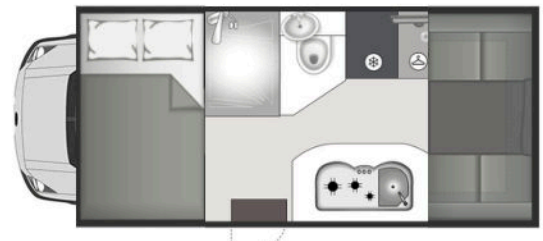

**CONQUEROR**

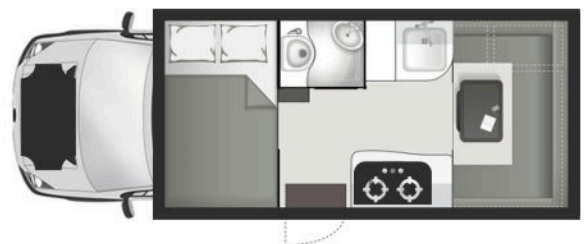

## SHERWOOD 4X4

The Sherwood 4x4, Suncamper's flagship model, is based on the Toyota Hilux and built tough for Australian off-road. It features a bed above the cab and spacious lounge area at the rear. The pocket table has no leg and can be easily stowed away when not in use. A full and functional kitchen has ample space and the motorhome has a toilet and hot water shower.

Although it has developed over time, we have been building the Sherwood for over 20 years. It is Australia's most popular four-wheel drive motorhome.



## THE MOTORHOME RANGE

Nearly all motorhomes and campervans are car-licensed, meaning no special drivers licence is required. Models evolve over time to ensure optimum design and functionality. Storage space is maximised and Suncamper are constantly sourcing the latest technologies to improve the travelling experience.

### SUNCAMPER MOTORHOMES

A division of Suncamper Pty Ltd

Unit 3  
9 Sefton Road  
Thornleigh NSW NSW 2100

T 1300 416 854  
[www.suncampermotorhomes.com.au](http://www.suncampermotorhomes.com.au)  
[sales@suncampermotorhomes.com.au](mailto:sales@suncampermotorhomes.com.au)

## THE BUILD

All motorhome models boast a steel frame base and aluminium, fully welded framework for the walls, rear, nose and single-piece roof. Walls and roof are fully insulated with fire-retardant foam and pressed. Framework is extensive so every fitting is screwed into a solid spot, not into insulation. The walls are more than 30mm thick and the roof is more than 45mm. This is more than double (and in some cases triple) other manufacturers.

Due to constant development, features and information may change without notice.





	<b>R SERIES</b>	<b>E SERIES</b>	<b>S SERIES</b>	<b>T SERIES</b>	<b>L SERIES</b>	<b>CONQUEROR</b>
<b>LENGTH</b>	<b>5800</b>	<b>5800</b>	<b>5800</b>	<b>5800</b>	<b>5800</b>	<b>5850</b>
<b>WIDTH</b>	<b>2000</b>	<b>2000</b>	<b>2000</b>	<b>2000</b>	<b>2000</b>	<b>2100</b>
<b>HEIGHT</b>	<b>3000</b>	<b>3250</b>	<b>3250</b>	<b>3250</b>	<b>3250</b>	<b>3000</b>
<b>2WD PETROL</b>	<b>2.7L</b>	<b>2.7L</b>	<b>-</b>	<b>2.7L</b>	<b>-</b>	<b>-</b>
<b>4WD DIESEL</b>	<b>-</b>	<b>2.8L T/D</b>	<b>2.8L T/D</b>	<b>2.8L T/D</b>	<b>2.8L T/D</b>	<b>2.8L T/D</b>
<b>GVM KG</b>	<b>3300</b>	<b>3450</b>	<b>3450</b>	<b>3450</b>	<b>3500</b>	<b>3620</b>
<b>TARE KG</b>	<b>2335</b>	<b>2680</b>	<b>2680</b>	<b>2680</b>	<b>2820</b>	<b>3140</b>
<b>BERTH</b>	<b>4</b>	<b>4</b>	<b>2</b>	<b>2-3</b>	<b>4</b>	<b>4</b>
<b>AIR CON</b>	<b>OPT.</b>	<b>Y</b>	<b>Y</b>	<b>Y</b>	<b>Y</b>	<b>OPT.</b>
<b>LCD T.V.</b>	<b>OPT.</b>	<b>Y</b>	<b>Y</b>	<b>Y</b>	<b>Y</b>	<b>Y</b>
<b>2 WAY FRIDGE</b>	<b>Y</b>	<b>2WD</b>	<b>-</b>	<b>2WD</b>	<b>-</b>	<b>Y</b>
<b>3 WAY FRIDGE</b>	<b>-</b>	<b>4WD</b>	<b>Y</b>	<b>4WD</b>	<b>Y</b>	<b>OPT.</b>
<b>STOVE</b>	<b>3-BURNER</b>	<b>3-BURNER</b>	<b>3-BURNER</b>	<b>3-BURNER</b>	<b>3-BURNER</b>	<b>2-BURNER</b>
<b>SINK</b>	<b>Y</b>	<b>Y</b>	<b>Y</b>	<b>Y</b>	<b>Y</b>	<b>BLACK OPT.</b>
<b>MICROWAVE</b>	<b>Y</b>	<b>Y</b>	<b>Y</b>	<b>Y</b>	<b>Y</b>	<b>OPT.</b>
<b>SHWR &amp; WC</b>	<b>Y</b>	<b>Y</b>	<b>Y</b>	<b>SEPERATE</b>	<b>SEPERATE</b>	<b>Y</b>
<b>FRESH WATER</b>	<b>86L</b>	<b>86L</b>	<b>86L</b>	<b>86L</b>	<b>86L</b>	<b>158L</b>
<b>WASTE TANK</b>	<b>43L</b>	<b>43L</b>	<b>43L</b>	<b>43L</b>	<b>43L</b>	<b>62L</b>
<b>SCREEN DOOR</b>	<b>LOCKABLE</b>	<b>LOCKABLE</b>	<b>LOCKABLE</b>	<b>LOCKABLE</b>	<b>LOCKABLE</b>	<b>LOCKABLE</b>
<b>REAR ST BELTS</b>	<b>OPT.*</b>	<b>OPT.*</b>	<b>-</b>	<b>-</b>	<b>OPT.*</b>	<b>OPT.*</b>
<b>STEP</b>	<b>MANUAL</b>	<b>ELECTRIC</b>	<b>ELECTRIC</b>	<b>ELECTRIC</b>	<b>ELECTRIC</b>	<b>ELECTRIC</b>
<b>AWNING</b>	<b>OPT.</b>	<b>Y</b>	<b>Y</b>	<b>Y</b>	<b>Y</b>	<b>Y</b>
<b>PANORAMIC WINDOWS</b>	<b>Y</b>	<b>Y</b>	<b>PARTIAL</b>	<b>-</b>	<b>Y</b>	<b>Y</b>

\*SEAT BELTS ARE SUBJECT TO WEIGHT REGULATIONS DEPENDING UPON OPTIONS AND ACCESSORIES FITTED.

\*\*DUE TO CONSTANT DEVELOPMENT, FEATURES AND INFORMATION MAY CHANGE WITHOUT NOTICE.

**SUNCAMPER MOTORHOMES**

A division of Suncamper Pty Ltd

Unit 3  
 9 Sefton Road  
 Thornleigh NSW NSW 2100

T 1300 416 854  
[www.suncampermotorhomes.com.au](http://www.suncampermotorhomes.com.au)  
[sales@suncampermotorhomes.com.au](mailto:sales@suncampermotorhomes.com.au)